

# AIRHOME

Efficient ventilation equipment for homes with heat recovery units



AIRHOME-350/V



Ventilation equipment with high-efficiency heat recovery, designed to guarantee thermal and acoustic comfort and low energy consumption, with multiple variants according to the needs of each home.

AIRHOME types available:

- AIRHOME and AIRHOME/V: Ventilation equipment with sensitive heat recovery unit (recovers only temperature).
- AIRHOME/E: Ventilation equipment with enthalpy heat recovery unit (recovers temperature and humidity).
- AIRHOME/R: Ventilation equipment with sensitive heat recovery unit with reversible airflow (configurable on the right or left).

- With 100% automatic by-pass.
- Centrifugal fan with constant flow control.
- Easy to remove filters for cleaning and maintenance.
- Operation compatible 50/60 Hz.
- Built-in filters, quality F7.
- Interior in lightweight expanded polypropylene and with low noise emissions.
- Low profile models for false ceiling installation.
- AIRHOME-350/V for vertical installation.
- Control compatible with MODBUS RTU.
- Very low noise level.
- Passive House certification for AIRHOME-150 and AIRHOME-350/V models.

Characteristics:

- Controlled mechanical ventilation system based on the extraction of stale air and the supply of fresh air.
- Counterflow sensible or enthalpy heat exchanger.

On request:

- Other filter combinations.

## Order code

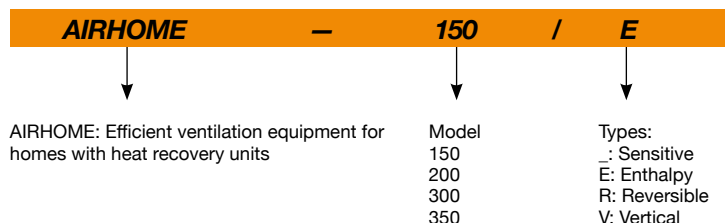

## Technical characteristics

Characteristics	AIRHOME-150	AIRHOME-150/E	AIRHOME-150/R	AIRHOME-200	AIRHOME-200/E	AIRHOME-300	AIRHOME-300/E	AIRHOME-350/V
Flow rate @100Pa (m <sup>3</sup> /h)	150	150	150	200	200	300	300	350
Thermal efficiency: EN 308	81.1 %	76.7%	81.1%	85.6%	76.6%	85.0%	83.1%	87.0 %
Thermal efficiency: UNE 13141-7	80.2 %	75.8%	80.2%	84.7%	75.1%	84.0%	82.6%	86.0 %
Constant flow regulation	YES	YES	YES	YES	YES	YES	YES	YES
Irradiated sound pressure at maximum flow rate (1,5 m) dB (A)	26	26	26	34	34	38	36	38
Electrical power (W)	60	60	60	80	80	180	180	267
Installation	False ceilings/Wall	False ceilings/Wall	False ceilings/Wall	False ceilings/Wall	False ceilings/Wall	False ceilings/Wall	False ceilings/Wall	Wall
Interchangeable nozzles	YES	YES	YES	YES	YES	YES	YES	YES
Nozzles diameter (mm)	125	125	125	125	125	125	125	160
Filters in external air supply	F7	F7	F7	F7	F7	F7	F7	F7
Remote control	Included	Included	Included	Included	Included	Included	Included	Included
Compatible with MODBUS RTU	YES	YES	YES	YES	YES	YES	YES	YES
Sensors in extraction of stale air	T°, RH, VOC, CO <sub>2</sub>	T°, RH, VOC, CO <sub>2</sub>	T°	T°, RH, VOC, CO <sub>2</sub>	T°, RH, VOC, CO <sub>2</sub>	T°, RH, VOC, CO <sub>2</sub>	T°, RH, VOC, CO <sub>2</sub>	T°, RH
Approx. weight (Kg)	23	23	23	23	23	36	36	40

**Dimensions mm**

**AIRHOME-150...300**

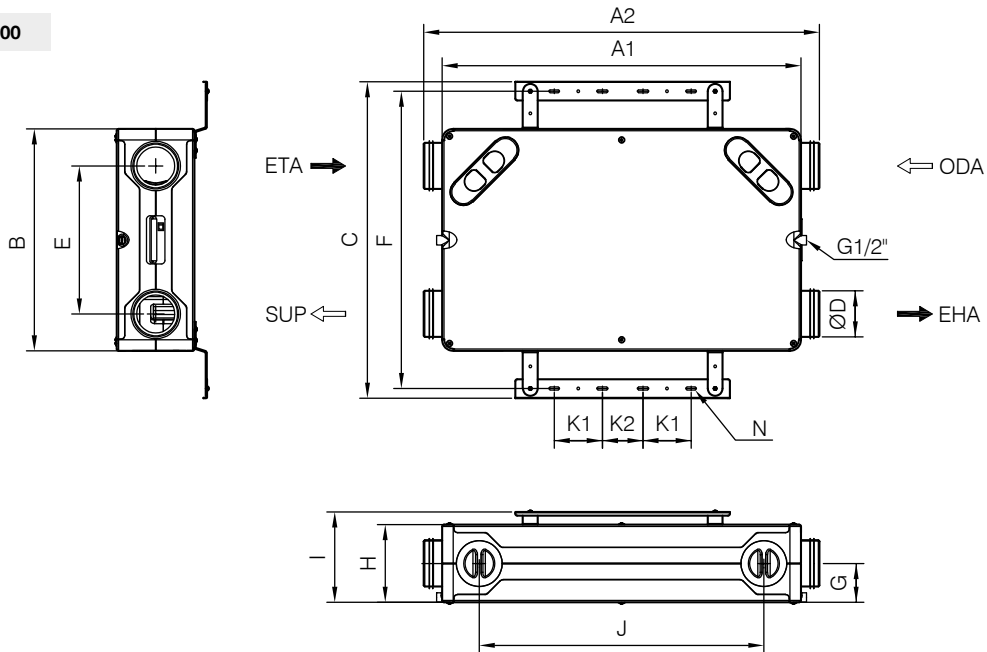

	A1	A2	B	C	D	E	F	G	H	I	J	K1	K2	N
AIRHOME-150	970	1070	600	855	125	400	803.5	105	210	244	770	130	110	8x30
AIRHOME-150/E	970	1070	600	855	125	400	803.5	105	210	244	770	130	110	8x30
AIRHOME-150/R	970	1070	600	855	125	400	803.5	105	210	244	770	130	110	8x30
AIRHOME-200	970	1070	600	855	125	400	803.5	105	210	244	770	130	110	8x30
AIRHOME-200/E	970	1070	600	855	125	400	803.5	105	210	244	770	130	110	8x30
AIRHOME-300	1140	1270	820	1072	160	510	1020	135	270	304	830	130	110	8x30
AIRHOME-300/E	1140	1270	820	1072	160	510	1020	135	270	304	830	130	110	8x30

**AIRHOME-350/V**

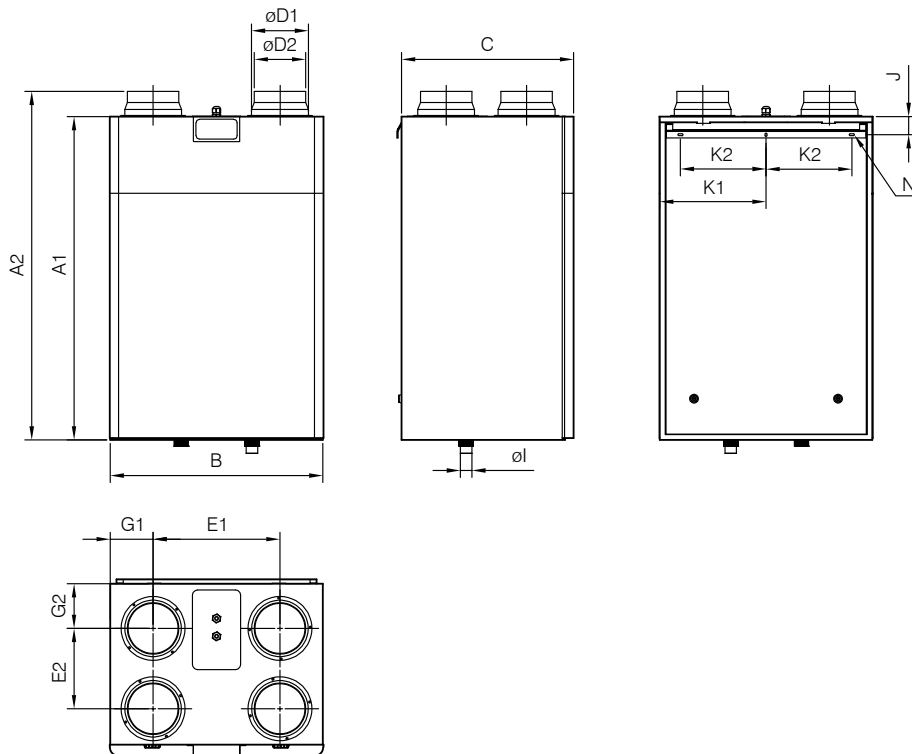

	A1	A2	B	C	D1	D2	E1	E2	G1	G2	I	J	K1	K2	N
AIRHOME-350/V	905	975	595	480	160	144	350	220	122.5	125.5	32	57	297	240	5.2x10

### Characteristic curves

Q= Flow rate in m<sup>3</sup>/h, m<sup>3</sup>/s and cfm

Pe= Static pressure in mm H<sub>2</sub>O, Pa and inwg

**AIRHOME-150**  
**AIRHOME-150/E**  
**AIRHOME-150/R**

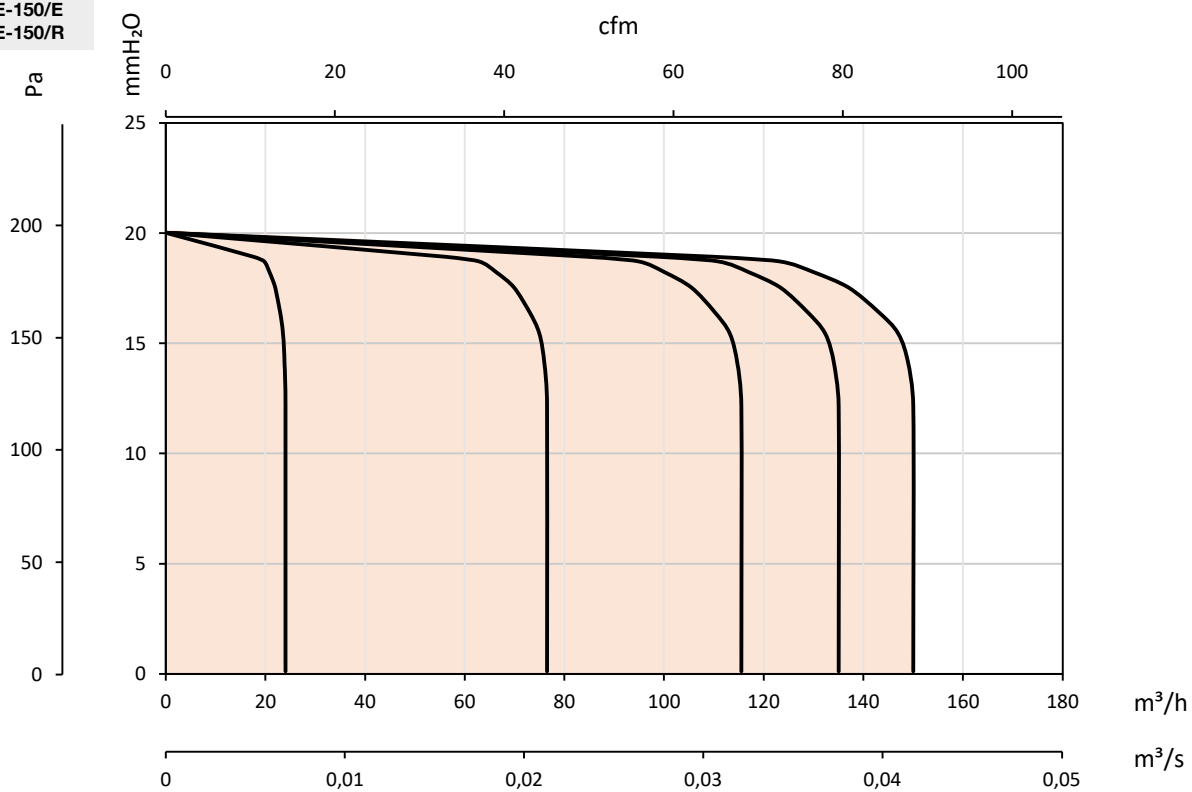

**AIRHOME-200**  
**AIRHOME-200/E**

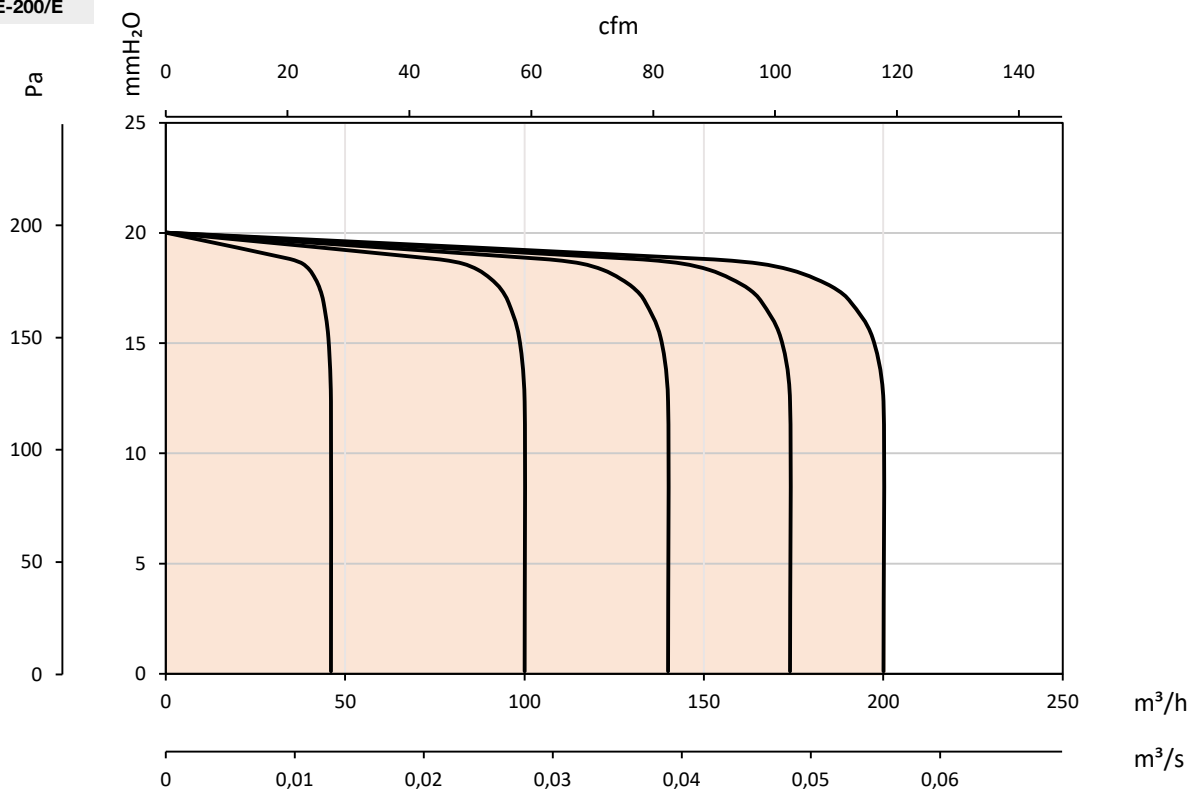

### Characteristic curves

Q= Flow rate in m<sup>3</sup>/h, m<sup>3</sup>/s and cfm

Pe= Static pressure in mm H<sub>2</sub>O, Pa and inwg

**AIRHOME-300**  
**AIRHOME-300/E**

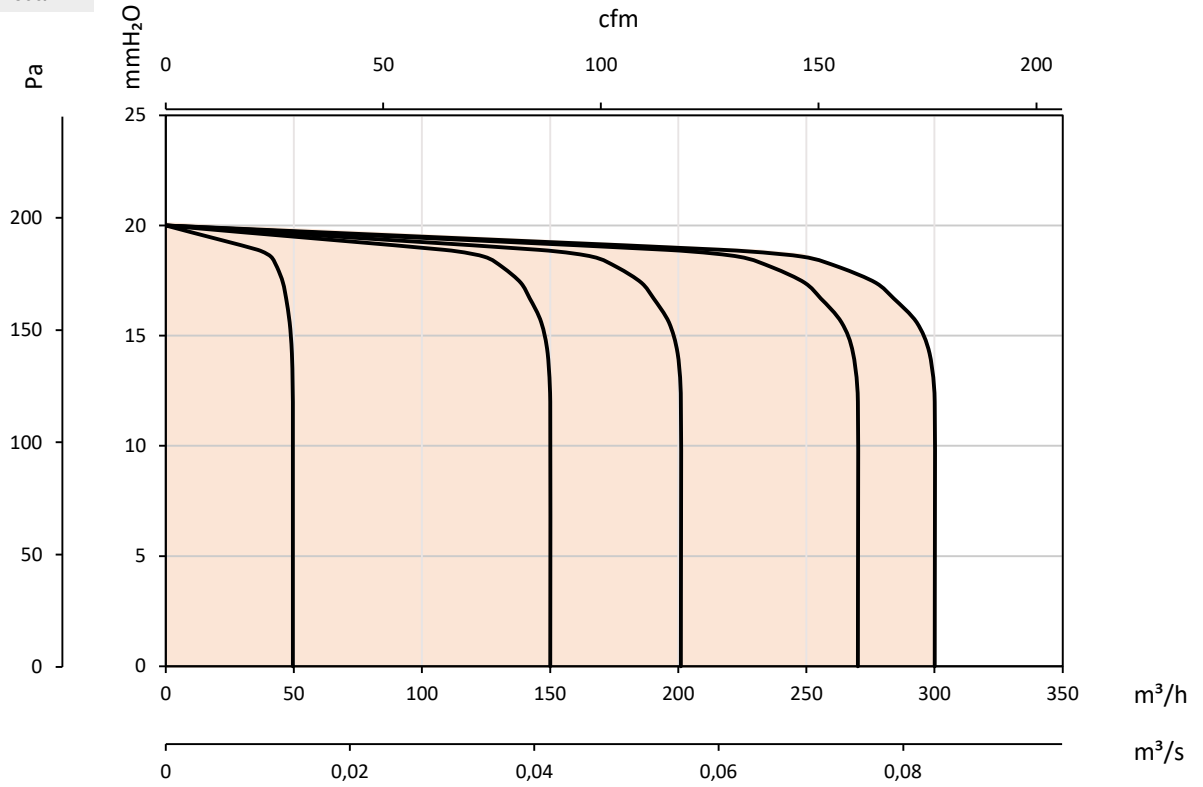

**AIRHOME-350/V**

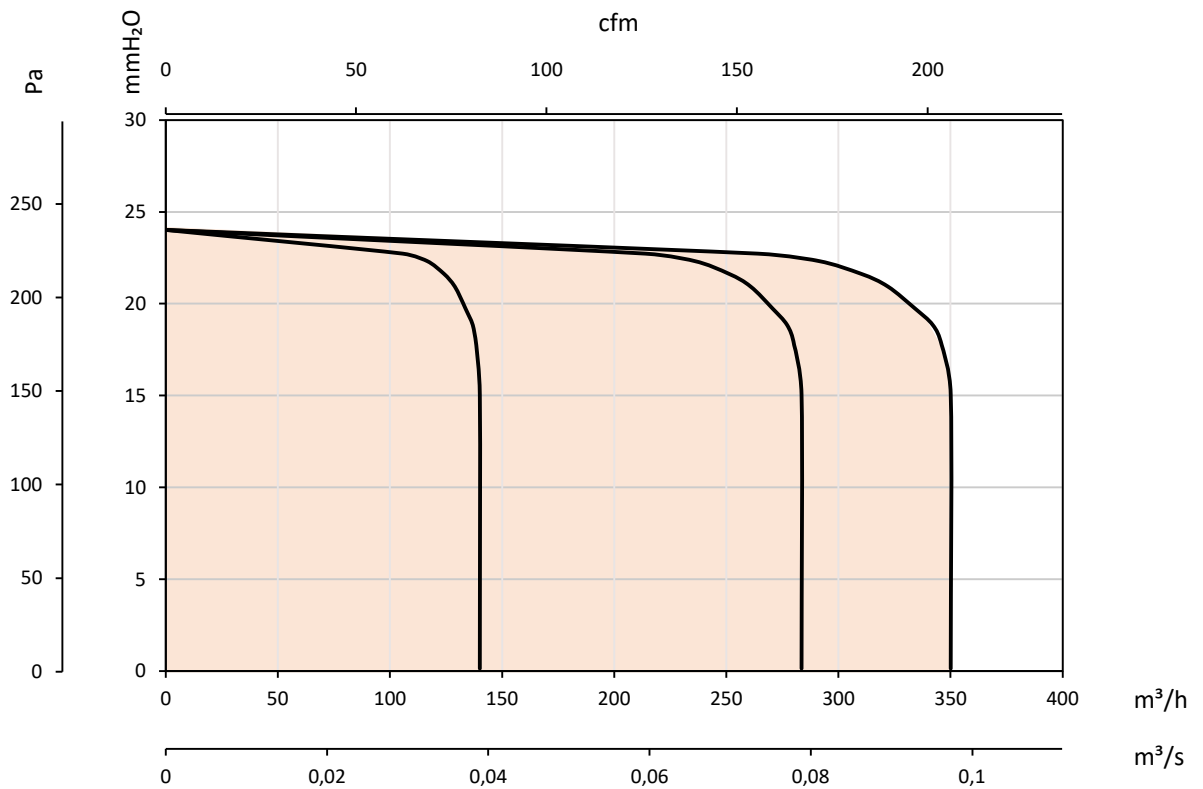

## Efficiency curves

— EN 308  
— UNE 13141-7

**AIRHOME-150**  
**AIRHOME-150/R**

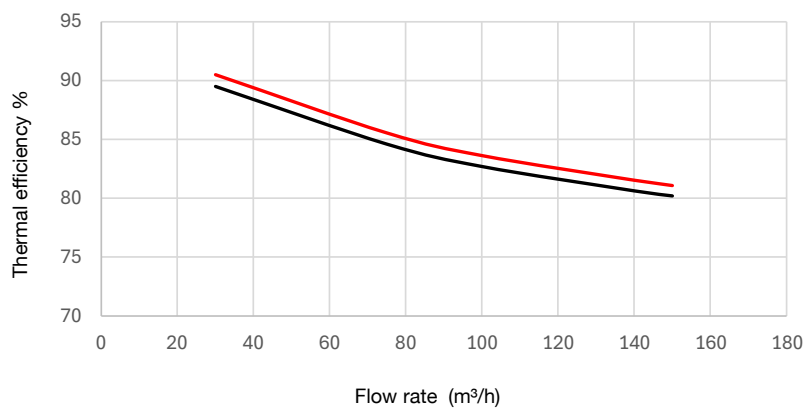

**AIRHOME-150/E**

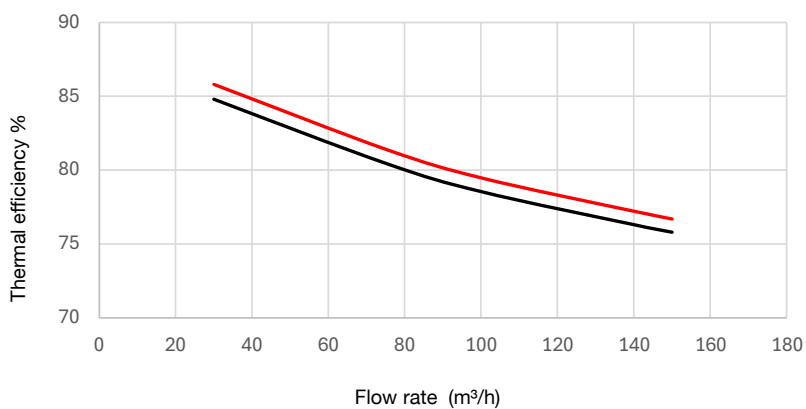

**AIRHOME-200**

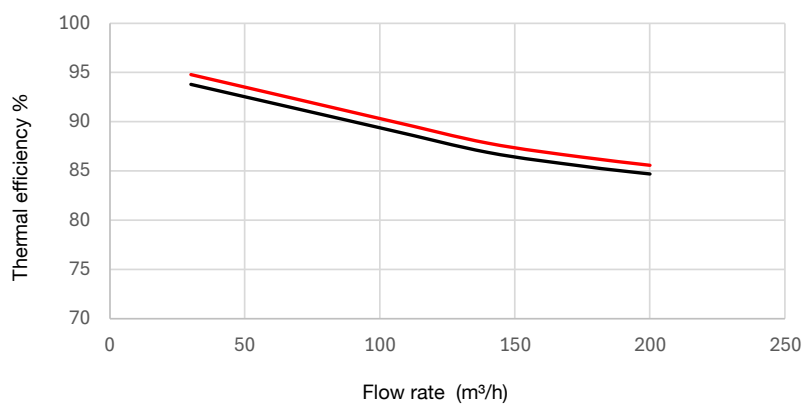

## Efficiency curves

— EN 308  
— UNE 13141-7

### AIRHOME-200/E

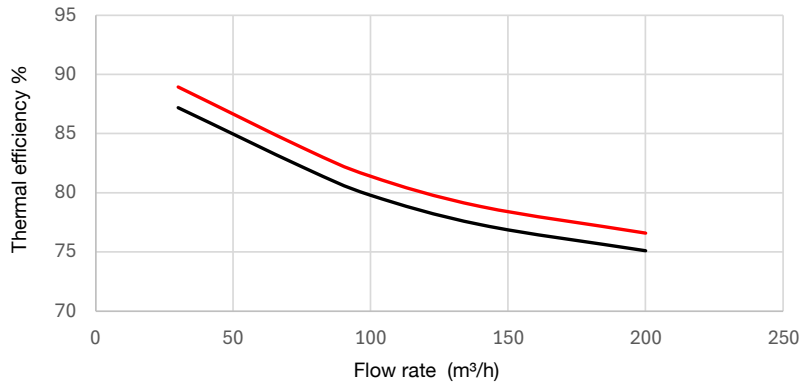

### AIRHOME-300

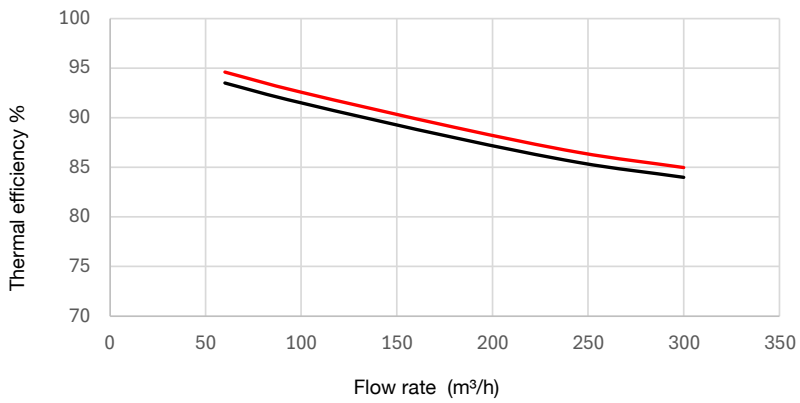

### AIRHOME-300/E

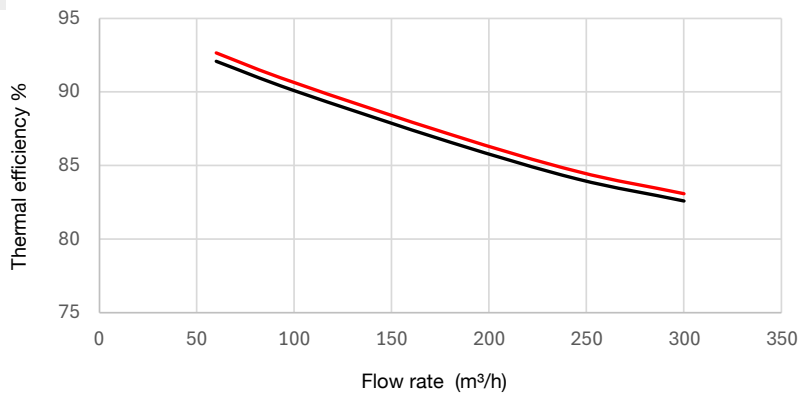

## Efficiency curves

— EN 308  
— UNE 13141-7

### AIRHOME-350/V

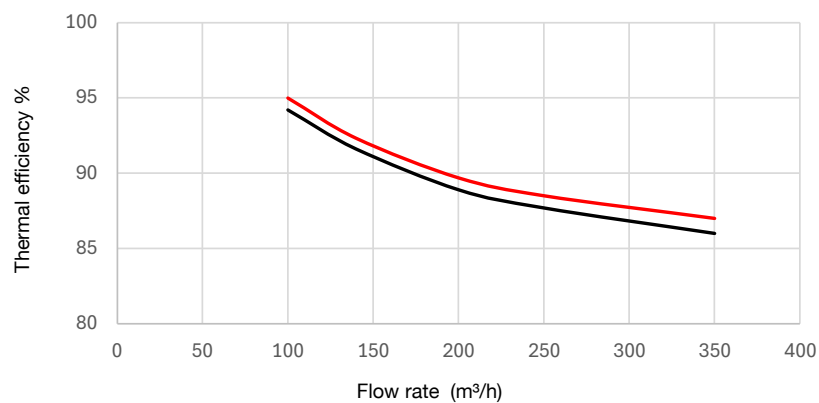

## Accessories



FILTROS



BE-AC



BI-AC



VMC-RC



VMC-PL



VMC-EXT

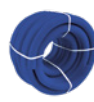

VMC-CSR



VMC-ME



VMC-CLP



VMC-CCP



VMC-BL



VMC-ADR



VMC-ADK



VMC-ADL



VMC-AN



VMC-R



VMC-JG



VMC-CUTTER



VMC-PLNC



VMC-TPN



VMC-MGT