

# REB

Heat recovery units with EC Technology motor and built-in by-pass



REB-15...120



REB-180...600-ST

Heat recovery units with EC Technology motor and built-in by-pass, low power consumption and heat recovery efficiency of over 86%.

**Characteristics:**

- Counterflow heat exchanger.
- With 100% automatic by-pass (except model REB-15).
- Low consumption fans with built-in regulation.
- Lateral maintenance access.
- Operation compatible 50/60 Hz.
- Particle filters with efficiencies depending on models.

Finishing on models REB-180-ST to REB-600-ST:

- Aluminium profile and pre-lacquered sheet steel structure with 25 mm thick thermal and acoustic insulation panels (upper and lower panels).
- Low profile models for false ceiling installation (REB-180-ST and REB-270-ST).
- For installation in technical rooms (REB-400-ST and REB-600-ST).
- Control compatible with MODBUS RTU.

Finishing on models REB-15 to REB-120:

- Equipment structure made of anti-corrosive galvanised sheet steel.
- Anti-condensation foam coating.
- Interior in lightweight expanded polypropylene and with low noise emissions.
- Low profile models for false ceiling installation.

## Order code

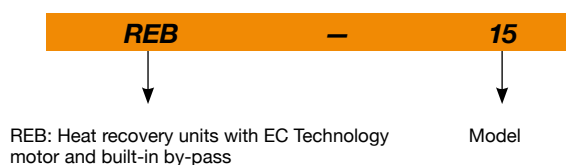

## Characteristics based on size

	REB-15	REB-25..120	REB-180...600-ST
Supply standard filters	G4	G4	F6+F8 or F7+F9
Extraction standard filters	G4	G4	F6 or F7
Second filter stage integrated in the fresh air circuit	-	-	YES
Free cooling function 100% of flow	-	YES	YES
Heat recovery type	Enthalpy	Enthalpy	Sensitive
Condensate exhaust	-	-	YES
Built-in pressure switches for filter condition control	-	-	YES
Maintenance switch	-	-	YES
Compatible with SI-CO2+HUMEDAD control	YES	YES	-
Control by MODBUS RTU	-	-	YES

## Technical characteristics

Model	Maximum flow rate (m <sup>3</sup> /h)	Total power (W)	Maximum admissible current (A)		Recovery efficiency (%)	Irradiated sound level at 5 m dB (A)	Approx. weight (Kg)
			220-240V II	380-415V III			
REB-15	180	60	0.26		72	38	18
REB-25	300	70	0.30		81	35	31
REB-40	480	90	0.39		82	37	39
REB-60	720	140	0.61		80	39	55
REB-80	960	300	1.30		82	41	72
REB-120	1440	325	1.41		79	42	91
REB-180-ST	2005	900	4.00		74	56	220
REB-270-ST	2440	1900	8.24		75	52	360
REB-400-ST	4585	3500	22.08		74	55	421
REB-600-ST	6425	2300		4.00	74	55	610



### Erp. (Energy Related Products)

Information on Directive 2009/125/EC can be downloaded from the SODECA website or the QuickFan selector programme.

## Characteristic curves

Q= Flow rate in m<sup>3</sup>/h, m<sup>3</sup>/s and cfm

Pe= Static pressure in mm H<sub>2</sub>O, Pa and inwg

REB-15-25-40

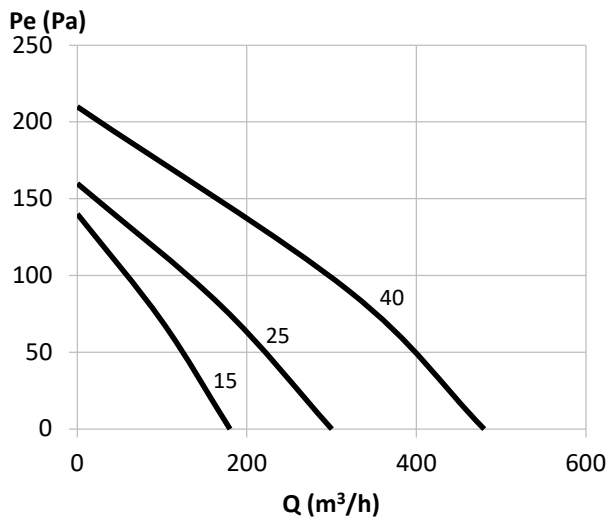

REB-60-80-120

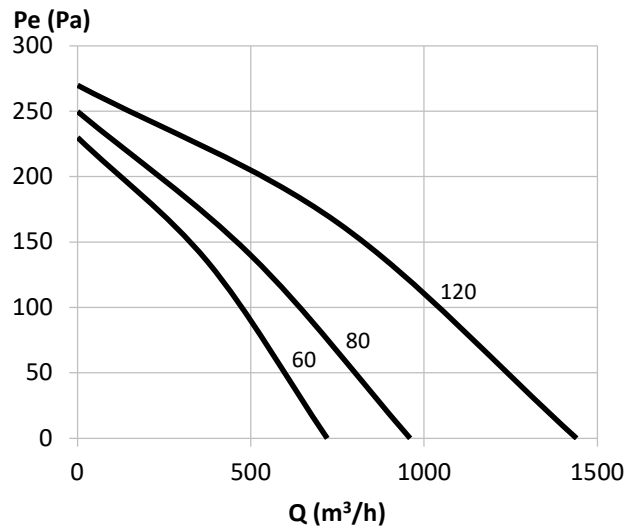

### Characteristic curves

Q= Flow rate in m<sup>3</sup>/h, m<sup>3</sup>/s and cfm

Pe= Static pressure in mm H<sub>2</sub>O, Pa and inwg

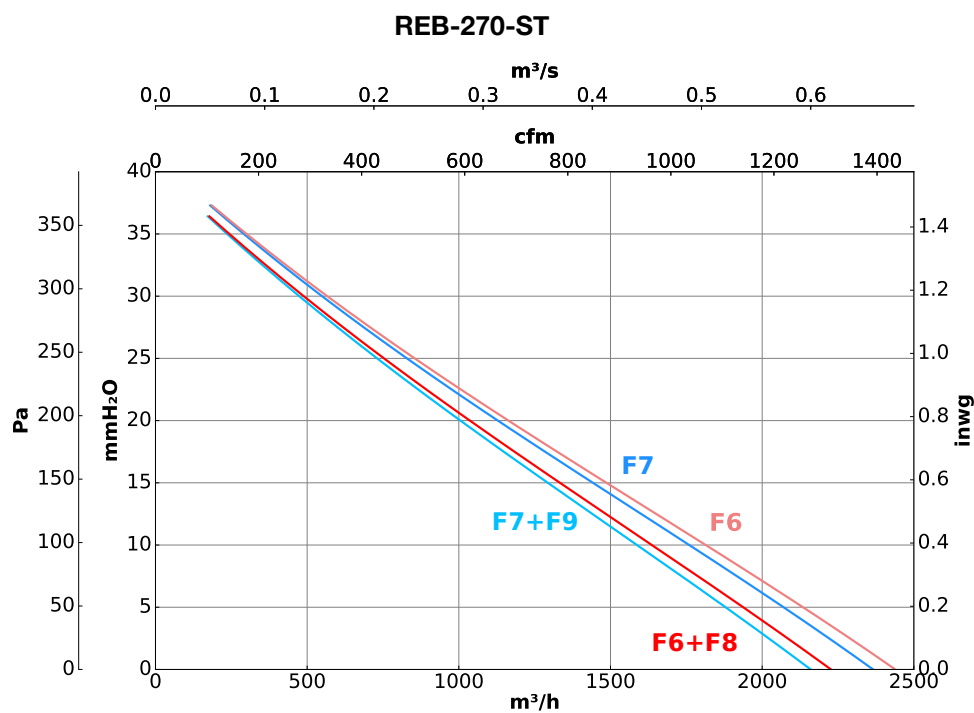
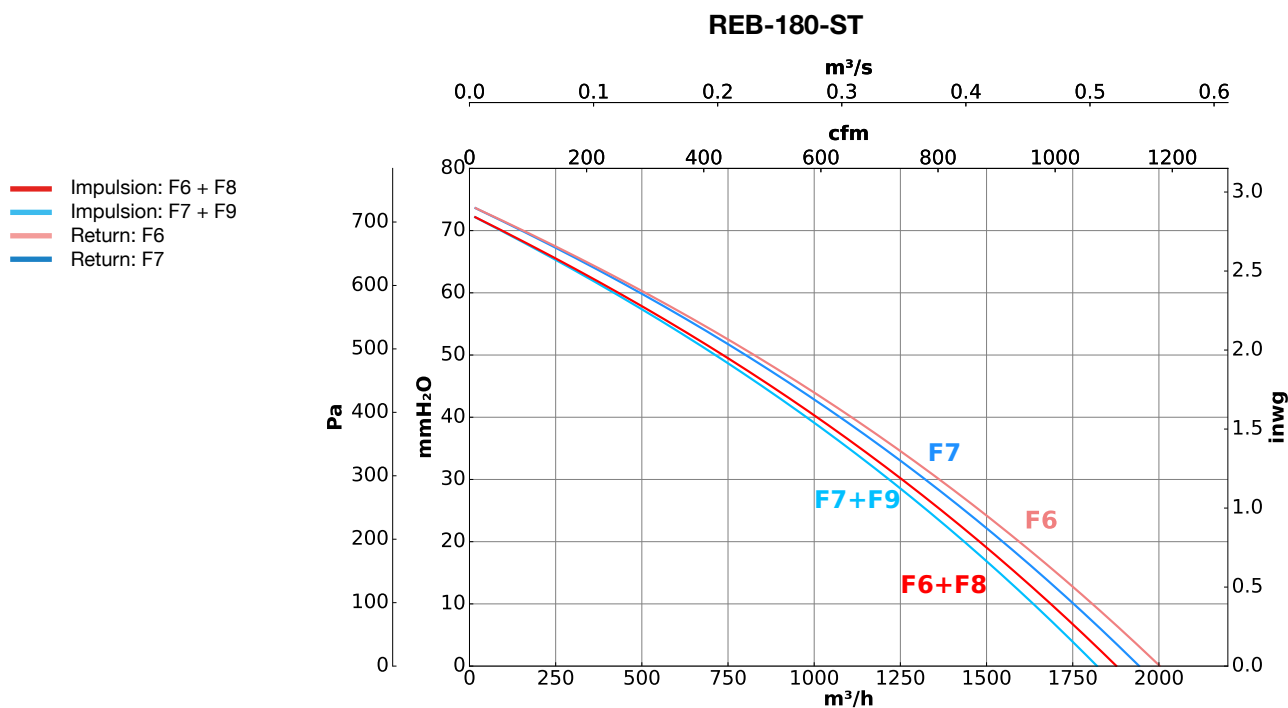

## Characteristic curves

Q= Flow rate in m<sup>3</sup>/h, m<sup>3</sup>/s and cfm

Pe= Static pressure in mm H<sub>2</sub>O, Pa and inwg

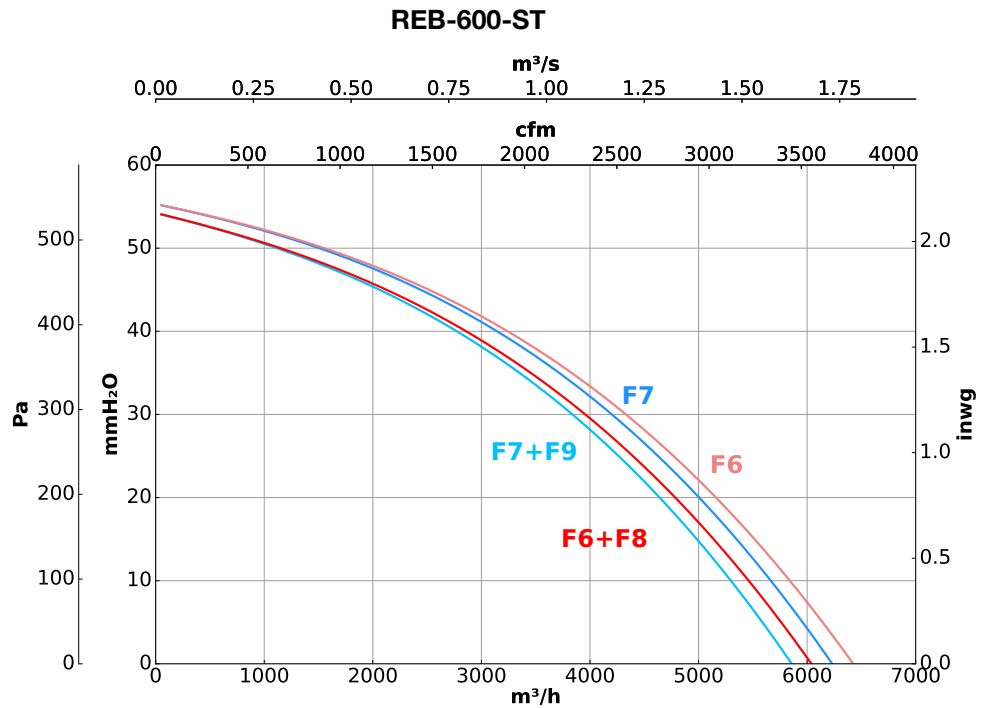
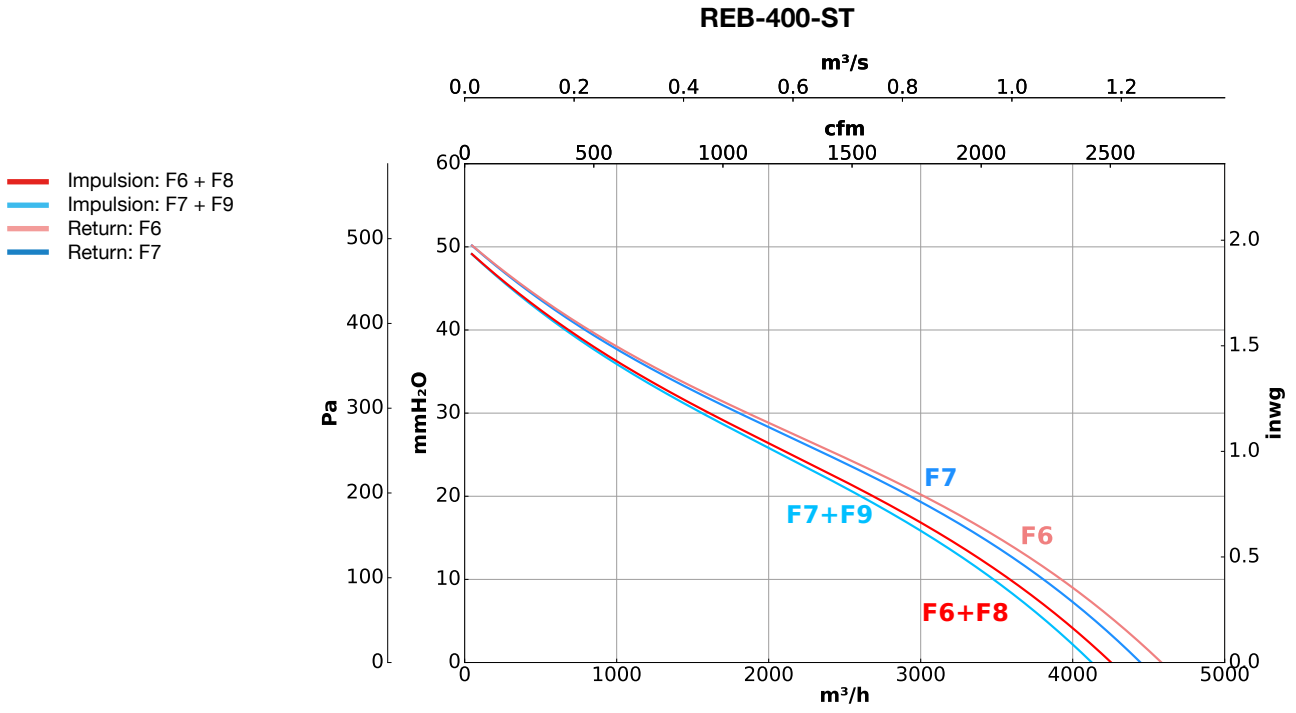

## Accessories



FILTROS



TEJ



SI-CO<sub>2</sub>+HÚMEDAD



SI-CO<sub>2</sub> IND



SONDA PRESIÓN DIFERENCIAL

## Dimensions mm

### REB-15...120

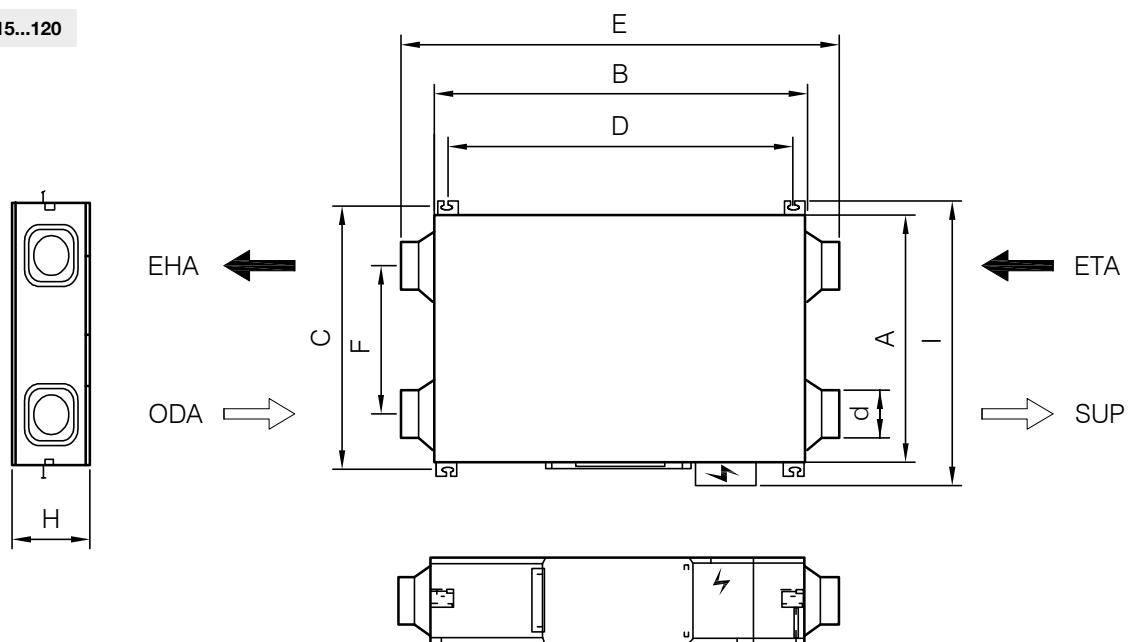

### REB-180...600-ST

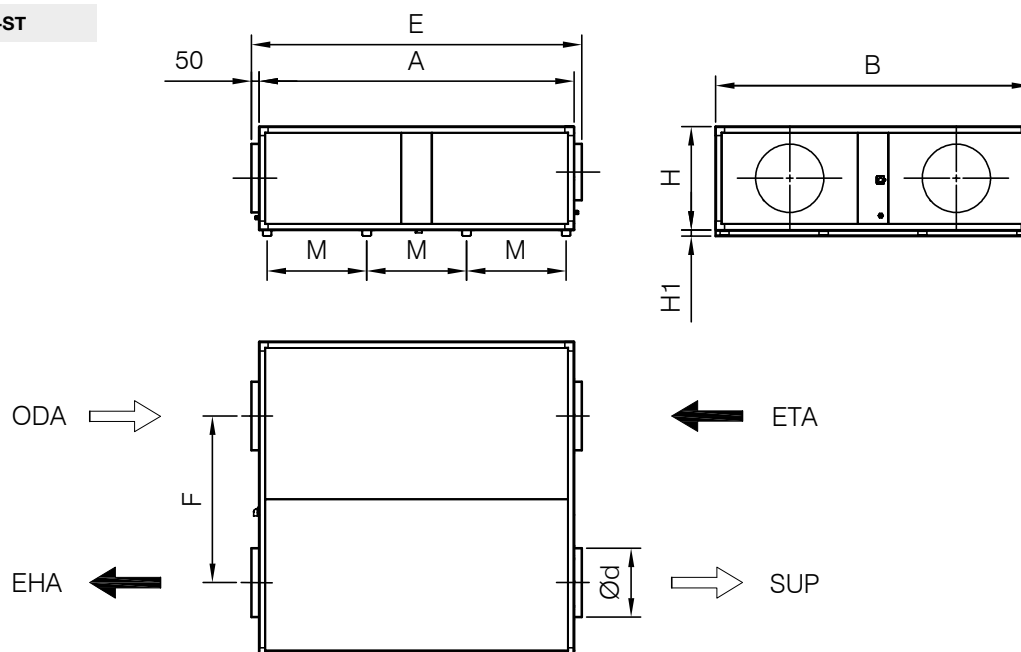

	A	B	C	D	d	E	F	H	H1	I	M
REB-15	510	883	560	813	97	1043	345	272	-	620	-
REB-25	675	890	735	820	146	1070	335	280	-	790	-
REB-40	813	888	863	818	146	1068	480	280	-	930	-
REB-60	995	970	1055	910	197	1130	728	313	-	1065	-
REB-80	883	1325	953	1255	247	1485	429	390	-	1000	-
REB-120	1132	1328	1202	1258	247	1488	680	395	-	1250	-
REB-180-ST	1500	1500	-	-	315	1600	810	580	-	-	-
REB-270-ST	1800	1800	-	-	450	1900	960	680	-	-	-
REB-400-ST	2070	2070	-	-	450	2170	1095	800	40	-	655
REB-600-ST	2070	2070	-	-	450	2170	1095	1150	40	-	655

ODA: Fresh outdoor air / SUP: Air supply to the premise / EHA: Exit of exhaust air / ETA: Air extraction from premises